

Style S416/S417

XtraSmall Linear Wall Mounted Uplight

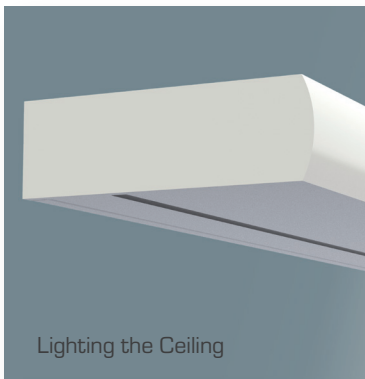

Lighting the Ceiling

Features

- Self-contained wall mounted luminaire - no need to build a cove
- Adjustable and lockable asymmetric upright
- ADA compliant - remote driver style S416 only
- Individually mounted or in continuous rows
- Optional through wiring harness with quick connectors

Performance

Precisely extruded acrylic lens produces an asymmetric distribution ideal for illuminating ceiling surfaces evenly.

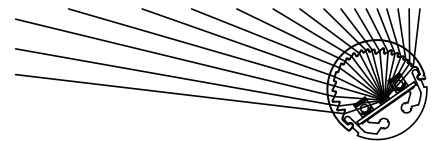
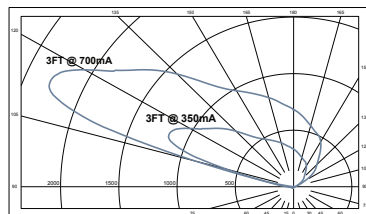

L85(17k) > 104,000 hrs. @ 25°C per TM-21

For LM79 and photometric reports, visit thelightingquotient.com

PROJECT	TYPE	CATALOG NUMBER
---------	------	----------------



1 STYLE

S416 = XtraSmall Wall Mounted Linear LED Asymmetric Uplight with Remote Driver

S417 = XtraSmall Wall Mounted Linear LED Asymmetric Uplight with Integral Driver

2 OUTPUT / POWER

- L** = Low output (3.3W per foot)
- S** = Standard output (6.5W per foot)
- H** = High output (13W per foot)

3 LENGTH

ORDER CODE	LENGTH	LUMENS	INPUT WATTS
2	2'	3319	28
3	3'	4979	41
4	4'	6638	55
5	5'	8298	69
6	6'	9957	83
7	7'	11617	96
8	8'	13277	110
9	9'	14936	124

Based on 3500K, 90+ CRI See [Scaled Performance Table](#)

4 ENCLOSURE STYLE

- A** = Rectangular with crescent front

5 FINISH * non-cancellable/non-returnable

- | | | |
|-----------------------------|--------------------------|---|
| 02 = Semigloss White | 13 = Matte Black* | 22 = Matte White* |
| 06 = Dark Bronze* | 15 = Metallic* | PL = Platinum* |
| 07 = Silver* | 17 = Champagne* | 99 = Custom or RAL
(Consult Rep.) |
| 08 = Semigloss Black | 18 = Copper* | |

02	22*	PL*	07*	15*
08	13*	06*	18*	17*

6 VOLTAGE

- M** = 120-277V Universal voltage input
- T** = 347V input

7 OPTIONS *(see Accessories Section for specifications)*

- 00** = No options
- 0M** = MRI option (style **S416** remote only)
- 0K** = Modular through-wire harness with quick connectors (style **S417** integral only)
- 0T** = Lay in top acrylic lens
- TK** = Lay in top lens and through wire harness (**S417** only)

8 DESTINATION REQUIREMENT

- 0** = CSA certified for U.S.
- J** = CSA certified for Canada

9 COLOR TEMPERATURE / CRI

- | | |
|-----------------------------|---|
| 927 = 2700K, 90+ CRI | D2W = Dim-to-Warm 2200K-3000K, 90+ CRI, other CCTs available |
| 930 = 3000K, 90+ CRI | TWH = Tunable White; 2700K-6500K, 90+ CRI |
| 935 = 3500K, 90+ CRI | RGB = Color Tunable; RGBW with 3500K, 90+ CRI white |
| 940 = 4000K, 90+ CRI | |

NOTE: Additional CCT and CRI options are available; consult factory.



Static



Dim2Warm



Tunable



RGBW

10 DIMMING

- 00** = Non-dimming
- ZX** = 0-10V analog dimming 120-277V or 347V input, dimming 100%-1%, 0-10V controls by others
- TD** = ERP forward or reverse phase 120V only, dimming 100%-6%, 120V phase controls by others
- EL** = 0-10V eldoLED SOLOdrive, 120-277V input, dimming 100%-0.1%, 0-10V controls by others
- ED** = DALI eldoLED SOLOdrive, 120-277V input, dimming 100%-0.1%, DALI controls by others
- DZ** = D2W or TWH 2-Channel driver for use with 0-10V controls by others
- DD** = D2W or TWH 2-Channel DALI driver (DALI controls by others)
- DA** = RGBW 4-Channel DMX module (DMX controls by others)
- DM** = RGBW 4-Channel eldoLED LINEARdrive (DMX controls by others)

Lighting the Ceiling XtraSmall Linear Wall Mounted Uplight

S416 Remote Driver (ADA Compliant)

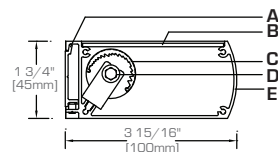

S417 Integral Driver

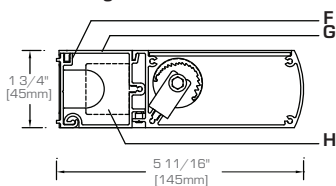

S417 Integral Driver Rear View

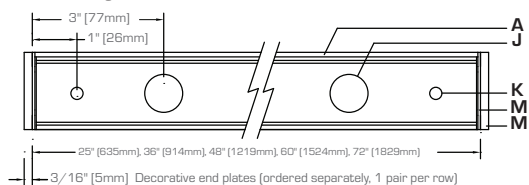

Installation

Secure mounting plate to ceiling, fasteners by others

Hang housing, connect supply wiring

Hinge closed, secure with screws

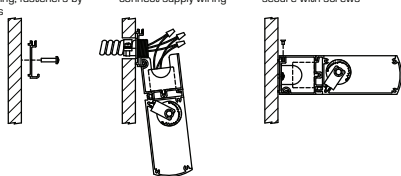

- A** Extruded aluminum mounting plate
- B** Optional top lens
- C** Extruded asymmetric lens
- D** Stainless steel spring washers and bolts
- E** Extruded aluminum housing
- F** Extruded aluminum mounting plate w/ hinge
- G** Extruded aluminum raceway/driver enclosure
- H** Electronic LED driver
- J** 7/8" dia. knock-outs (1 each end)
- K** 9/32" Dia. mounting holes
- L** Stamped aluminum reveal plate
- M** Stamped aluminum end plates (ordered separately)

Specifications

Housing and Optic Assembly:

Extruded aluminum housing. Internal extruded aluminum heat sink is anodized for maximum emissivity. Precision extruded polymer refractive lens with optimal diffusion.

Finish:

Extruded aluminum heat sink/housing bright anodized, white or black finish. Formed aluminum canopy, adjustable back bracket, end plates finished white, black or anodized. Painted surfaces – 6 stage pretreatment and electrostatically applied thermoset polyester powder coating for a durable abrasion, fade and corrosion resistant finish. All hardware – stainless steel or nickel plated brass.

Mounting:

Mounting plate provided with 9/32" (7mm) diameter mounting holes. Mounting plate fastens to wall (fasteners by others). Luminaire hooks onto wall plate and is secured with fasteners provided. When mounting in continuous rows, leave 1/8" gap between wall plates.

Electrical:

Style S416 remote driver units are furnished with 7 foot (2438mm) leads for connection to remote driver Class II output. Remote electronic HPF thermally protected Class II driver mounted in aluminum enclosure. Style S417 integral driver units are provided with (2) 7/8" knock outs for supply connection. For complete driver specifications, see website, reference document [MA-1303](#). Optional electronic dimming driver; compatible dimming controls (by others). See website for dimming compatibility and specifications.

Standard:

CSA certified for dry locations. 5 year warranty, maximum ambient temperature 45°C (113°F).

Required Mounting Hangers

Accessories

Order separately. See Accessories Section for specifications.

ADE  **O = Decorative end plates** (pair), one pair required for each individual fixture or row

5 Finish Specify finish to match housing finish

AR = Decorative end plates for Style S418 (remote driver housing)
AN = Decorative end plates for Style S419 (integral driver housing)

Controls

LiQ luminaires are compatible with a wide variety of wired and wireless controls and sensors. See [Controls Information](#).

AWB-TP-DMX-0 = RGBW LED dimmer switch fits in a standard wall switch box and provides on/off control as well as fixed levels of dimmability. The dimmer switch has a color-selection wheel for thousands of color options, 10 dynamic color-changing/single color modes, 0-100% dimming, on/off controls, and 4 color-specific channel controls for red, green, blue, and white.

Additional wired and wireless controls available, see [Driver and Controls Information](#).

