

style S409/S410

Large indoor, integral driver

LiQ
... Lighting IQ Rising
The Lighting quotient



Pan Am Pool Renovation | Architect/Engineer: **Stantec** | Photography: Jing Jia



Lighting the Ceiling

Features

- High light output - up to 65,348 lumens delivered
- Maintains over 80% of initial light output beyond 60,000 hours per TM-21
- 2700K through 4000K at 90+ CRI
- Adjustable and lockable aiming with aiming index
- Suitable for damp locations and natatorium use

Performance

Precisely extruded acrylic lens produces an asymmetric distribution ideal for illuminating surfaces evenly.

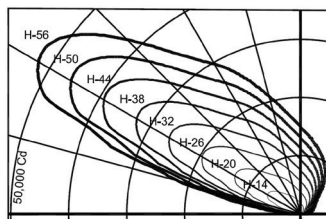

L85(17k) > 104,000 hrs. @ 25°C per TM-21

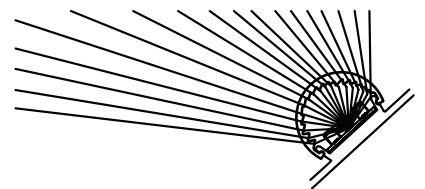

For LM79 and photometric reports, visit thelightingquotient.com

PROJECT		TYPE																																					
<div> <div>S</div> <div>4</div> <div></div> <div></div> <div></div> <div></div> <div></div> <div></div> <div></div> <div></div> </div> <div>1 2 3 4 5 6 7 8 9 10</div>		<div>CATALOG NUMBER</div>																																					
<div>1</div> <div>STYLE</div> <p> S409 = Large surface asymmetric upright - angular shroud S410 = Large surface asymmetric upright - rounded shroud </p>		<div>6</div> <div>VOLTAGE</div> <p> M = 120-277V Universal voltage input T = 347V input </p>																																					
<div>2</div> <div>OUTPUT / POWER</div> <p> S = Standard output H = High output </p>		<div>7</div> <div>OPTIONS <i>(see Accessories Section for specifications)</i></div> <p> 00 = Cutoff visor included, no other options OP = <u>Natatorium</u> (pool) use XX = For modification not listed, include detailed description. Consult factory prior to specification </p>																																					
<div>3</div> <div>LENGTH</div> <table border="1"> <thead> <tr> <th>ORDER CODE</th> <th>LENGTH</th> <th>LUMENS</th> <th>INPUT WATTS</th> </tr> </thead> <tbody> <tr><td>14</td><td>14"</td><td>9075</td><td>84</td></tr> <tr><td>20</td><td>20"</td><td>18362</td><td>168</td></tr> <tr><td>26</td><td>26"</td><td>27600</td><td>252</td></tr> <tr><td>32</td><td>32"</td><td>37804</td><td>336</td></tr> <tr><td>38</td><td>38"</td><td>47673</td><td>420</td></tr> <tr><td>44</td><td>44"</td><td>59716</td><td>503</td></tr> <tr><td>50</td><td>50"</td><td>67913</td><td>587</td></tr> <tr><td>56</td><td>56"</td><td>75609</td><td>671</td></tr> </tbody> </table> <p><i>Based on 3500K, 90+ CRI See Scaled Performance Table</i></p>		ORDER CODE	LENGTH	LUMENS	INPUT WATTS	14	14"	9075	84	20	20"	18362	168	26	26"	27600	252	32	32"	37804	336	38	38"	47673	420	44	44"	59716	503	50	50"	67913	587	56	56"	75609	671	<div>8</div> <div>DESTINATION REQUIREMENT</div> <p> O = CSA certified for U.S. J = CSA certified for Canada </p>	
ORDER CODE	LENGTH	LUMENS	INPUT WATTS																																				
14	14"	9075	84																																				
20	20"	18362	168																																				
26	26"	27600	252																																				
32	32"	37804	336																																				
38	38"	47673	420																																				
44	44"	59716	503																																				
50	50"	67913	587																																				
56	56"	75609	671																																				
<div>4</div> <div>MOUNTING</div> <p> W = Wall mount over recessed outlet box. S = Wall mount side surface conduit. T = Wall mount top surface conduit. 1 = 1-way pendant upright, one fixture - required mounting hanger ordered and priced separately. 2 = 2-way pendant upright, two fixtures - required mounting hanger ordered and priced separately. NOTE: Not for use with 50" or 56" lengths </p>		<div>9</div> <div>COLOR TEMPERATURE / CRI</div> <table border="0"> <tbody> <tr> <td>927 = 2700K, 90+ CRI</td> <td>D2W = Dim-to-Warm 2200K-3000K, 90+ CRI, other CCTs available</td> </tr> <tr> <td>930 = 3000K, 90+ CRI</td> <td>TWH = Tunable White; 2700K-6500K, 90+ CRI</td> </tr> <tr> <td>935 = 3500K, 90+ CRI</td> <td>RGB = Color Tunable; RGBW with 3500K, 90+ CRI white</td> </tr> <tr> <td>940 = 4000K, 90+ CRI</td> <td></td> </tr> </tbody> </table> <p>NOTE: Additional CCT and CRI options are available; consult factory.</p> <div> <div>static white</div> <div>Dim 2 Warm</div> <div>tunable white</div> <div>rgbw</div> <div>Static</div> <div>Dim2Warm</div> <div>Tunable</div> <div>RGBW</div> </div>		927 = 2700K, 90+ CRI	D2W = Dim-to-Warm 2200K-3000K, 90+ CRI, other CCTs available	930 = 3000K, 90+ CRI	TWH = Tunable White; 2700K-6500K, 90+ CRI	935 = 3500K, 90+ CRI	RGB = Color Tunable; RGBW with 3500K, 90+ CRI white	940 = 4000K, 90+ CRI																													
927 = 2700K, 90+ CRI	D2W = Dim-to-Warm 2200K-3000K, 90+ CRI, other CCTs available																																						
930 = 3000K, 90+ CRI	TWH = Tunable White; 2700K-6500K, 90+ CRI																																						
935 = 3500K, 90+ CRI	RGB = Color Tunable; RGBW with 3500K, 90+ CRI white																																						
940 = 4000K, 90+ CRI																																							
<div>5</div> <div>FINISH * non-cancellable/non-returnable</div> <table border="0"> <tbody> <tr> <td>02 = Semigloss White</td> <td>13 = Matte Black*</td> <td>22 = Matte White*</td> </tr> <tr> <td>06 = Dark Bronze*</td> <td>15 = Metallic*</td> <td>PL = Platinum*</td> </tr> <tr> <td>07 = Silver*</td> <td>17 = Champagne*</td> <td>99 = Custom or RAL (Consult Rep.)</td> </tr> <tr> <td>08 = Semigloss Black</td> <td>18 = Copper*</td> <td></td> </tr> </tbody> </table> <table border="1"> <tbody> <tr> <td>02</td> <td>22*</td> <td>PL*</td> <td>07*</td> <td>15*</td> </tr> <tr> <td>08</td> <td>13*</td> <td>06*</td> <td>18*</td> <td>17*</td> </tr> </tbody> </table>		02 = Semigloss White	13 = Matte Black*	22 = Matte White*	06 = Dark Bronze*	15 = Metallic*	PL = Platinum*	07 = Silver*	17 = Champagne*	99 = Custom or RAL (Consult Rep.)	08 = Semigloss Black	18 = Copper*		02	22*	PL*	07*	15*	08	13*	06*	18*	17*	<div>10</div> <div>DIMMING</div> <p> 00 = Non-dimming ZX = 0-10V analog dimming 120-277V or 347V input, dimming 100%-1%, 0-10V controls by others TD = ERP forward or reverse phase 120V only, dimming 100%-6%, 120V phase controls by others EL = 0-10V eldoLED SOLOdrive, 120-277V input, dimming 100%-0.1%, 0-10V controls by others ED = DALI eldoLED SOLOdrive, 120-277V input, dimming 100%-0.1%, DALI controls by others DZ = D2W or TWH 2-Channel driver for use with 0-10V controls by others DD = D2W or TWH 2-Channel DALI driver (DALI controls by others) DA = RGBW 4-Channel DMX module (DMX controls by others) DM = RGBW 4-Channel eldoLED LINEARdrive (DMX controls by others) </p>															
02 = Semigloss White	13 = Matte Black*	22 = Matte White*																																					
06 = Dark Bronze*	15 = Metallic*	PL = Platinum*																																					
07 = Silver*	17 = Champagne*	99 = Custom or RAL (Consult Rep.)																																					
08 = Semigloss Black	18 = Copper*																																						
02	22*	PL*	07*	15*																																			
08	13*	06*	18*	17*																																			

Lighting the Ceiling Large indoor, integral driver

W Mount

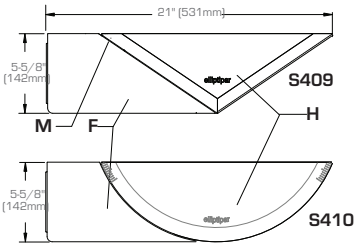

T Mount

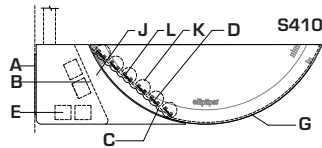

Mounting Plate (W Mount)

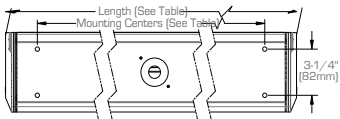

LENGTH	#LEDs	LENGTH	MOUNTING	WEIGHT
14	144	13.5" (343mm)	9" (229mm)	17 lb (7.8 kg)
20	288	19.5" (495mm)	15" (381mm)	23 lb (10.5 kg)
26	432	25.5" (648mm)	21" (533mm)	27 lb (12.3 kg)
32	576	31.5" (800mm)	27" (686mm)	34 lb (15.5 kg)
38	720	37.5" (953mm)	33" (838mm)	40 lb (18.2 kg)
44	864	43.5" (1105mm)	39" (991mm)	45 lb (20.5 kg)
50	1008	49.5" (1257mm)	45" (1143mm)	51 lb (23.2 kg)
56	1153	55.5" (1410mm)	51" (1295mm)	57 lb (25.9 kg)

- A Extruded Aluminum Mounting Plate
- B Extruded Aluminum Driver Housing
- C Extruded Aluminum heat sink
- D LED Light Engine
- E Integral Electronic Driver
- F Aluminum Endplate
- G Extruded Aluminum Visor
- H Cast Aluminum Endcap
- J Aluminum Side Arms
- K Proprietary Extruded Polycarbonate Prismatic Optic
- L LED Board
- M Aiming Index Marks

Specifications

Housing and Optic Assembly:

Two-piece extruded aluminum heat sink housing and light engine. Exterior heat sink anodized for maximum emissivity. Precision extruded polymer refractive lens with optimized asymmetric distribution. Stainless steel hardware.

Finish:

Painted surfaces – 6 stage pretreatment and electrostatically applied thermoset polyester powder coating for a durable abrasion, fade and corrosion resistant finish. Extruded aluminum visor. Extruded aluminum heat sink/housing, mounting arms, and decorative end plates are finished in semigloss white. All luminaire hardware is stainless steel; mounting hardware is zinc or electroplated steel.

Mounting:

Mounting plate covers recessed outlet box or conduit feed and forms reveal at wall. Suitable backing structure required (by others). Fixture hinges on plate for hands-free access to splices. Required upright pendant mounting assembly utilizes mounting hangers (see pg. SC12.1) ordered and priced separately; specify **1** or **2** mount.

Electrical:

Use 90°C wire for supply connections. Integral electronic HPF constant current driver. For complete driver specifications, see website, reference document [MA-1303](#).

Standard:

CSA certified to UL1598, UL8750, CSA C22.2 for dry locations; specify VP option for damp locations. Where pendant or cantilever may be exposed to wind, consult factory. 5 year warranty, maximum ambient temperature 40°C (104°F).

Controls

LiQ luminaires are compatible with a wide variety of wired and wireless controls and sensors. See [Controls Information](#).

AWB-TP-DMX-0 = RGBW LED dimmer switch fits in a standard wall switch box and provides on/off control as well as fixed levels of dimmability. The dimmer switch has a color-selection wheel for thousands of color options, 10 dynamic color-changing/single color modes, 0-100% dimming, on/off controls, and 4 color-specific channel controls for red, green, blue, and white.

Additional wired and wireless controls available, see [Driver and Controls Information](#).



Required Mounting Hangers

Accessories

Order separately. See accessories section for specifications.

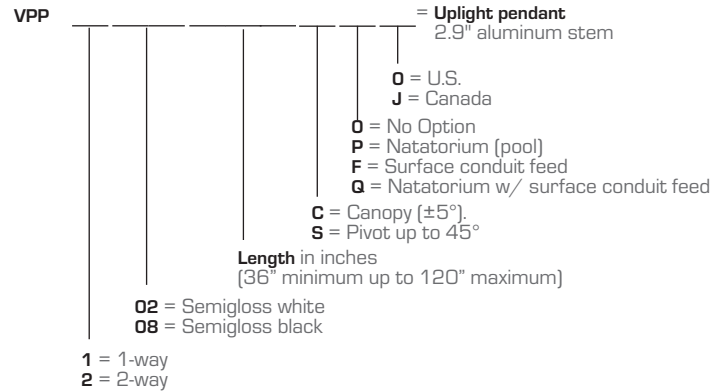

NOTE: Suitable structure required to support up to 150 lb/70 kg. For additional pendant specifications, see [thelightingquotient.com](#).

