

# style S320

Xtra-small Cove / Concealed,  
Integral Driver



MetLife Headquarters, New York, NY | Interiors: Rockwell Group | Lighting: Hillman DiBernardo Associates | Photography: Paul Warchol



## Features

- Asymmetric distribution – uniform surface illumination
- Fully adjustable and lockable aiming
- Integral driver
- Optional thru-wire harness with quick connectors
- Compatible with LumiLedge® prefabricated cove framing

## Performance

Precisely extruded acrylic lens produces an asymmetric distribution ideal for illuminating ceilings evenly.

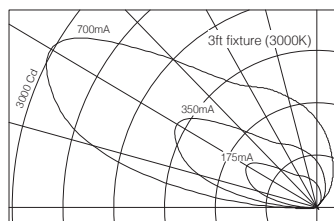

L85(17k) > 104,000 hrs. @ 25°C per TM-21  
L85(9k) > 54,000 hrs. @ 25°C per TM-21

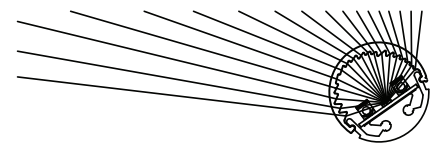

For LM79 and photometric reports, visit [thelightingquotient.com](http://thelightingquotient.com)



PROJECT				TYPE				CATALOG NUMBER			
S	3	2	0								
1	2	3	4	5	6	7	8	9	10		

1

STYLE

**S320** = XtraSmall Concealed/Cove Asymmetric Adjustable with integral driver

2

OUTPUT / POWER

**L** = Low output (3.3W per foot)  
**S** = Standard output (6.5W per foot)  
**H** = High output (13W per foot)

3

LENGTH

ORDER CODE	LENGTH	LUMENS	INPUT WATTS
2	24"	3713	28
3	35 3/4"	5570	41
4	47 1/4"	7427	55
5	59"	9283	69
6	70 5/8"	11140	83
7	82 1/4"	12997	96
8	94"	15193	110

*Based on 3500K, 90+ CRI See [Scaled Performance Table](#)*

4

MOUNTING

**S** = Surface mounted in cove or LumiEdge® cove framing (ordered and priced separately)  
**7** = For use with [LLSR-FR7](#) LumiEdge® cove framing (ordered and priced separately)

5

FINISH

**00** = Anodized optical housing/heat sink; mill finish brackets and driver enclosure; stainless steel luminaire hardware (natatorium use option is painted)  
**02** = For damp / natatorium use. Driver enclosure and mounting brackets finished semi-gloss white, optical housing/heat sink are bright anodized

6

VOLTAGE

**M** = 120-277V Universal voltage input  
**K** = 347V input

7

OPTIONS *(see Accessories Section for specifications)*

**00** = No options  
**OK** = Modular through-wire harness with quick connectors  
**OE** = Emergency driver (Operates LEDs as lower output for 90 minutes)  
**EK** = Emergency driver with through-wire harness

8

DESTINATION REQUIREMENT

**O** = ETL listed for U.S.  
**J** = ETL listed for Canada

9

COLOR TEMPERATURE / CRI

**927** = 2700K, 90+ CRI      **D2W** = Dim-to-Warm 2200K-3000K, 90+ CRI, other CCTs available  
**930** = 3000K, 90+ CRI      **TWH** = Tunable White; 2700K-6500K, 90+ CRI  
**935** = 3500K, 90+ CRI      **RGB** = Color Tunable; RGBW with 3500K, 90+ CRI white  
**940** = 4000K, 90+ CRI

**NOTE:** Additional CCT and CRI options are available; consult factory.

10

DIMMING

**00** = Non-dimming  
**ZX** = 0-10V analog dimming 120-277V or 347V input, dimming 100%-1%, 0-10V controls by others  
**TD** = ERP forward or reverse phase 120V only, dimming 100%-6%, 120V phase controls by others  
**EL** = 0-10V eldoLED SOLOdrive, 120-277V input, dimming 100%-0.1%, 0-10V controls by others  
**ED** = DALI eldoLED SOLOdrive, 120-277V input, dimming 100%-0.1%, DALI controls by others  
**DZ** = D2W or TWH 2-Channel driver for use with 0-10V controls by others  
**DD** = D2W or TWH 2-Channel DALI driver (DALI controls by others)  
**DA** = RGBW 4-Channel DMX module (DMX controls by others)

Lighting the Ceiling Xtra-small Cove / Concealed, Integral Driver

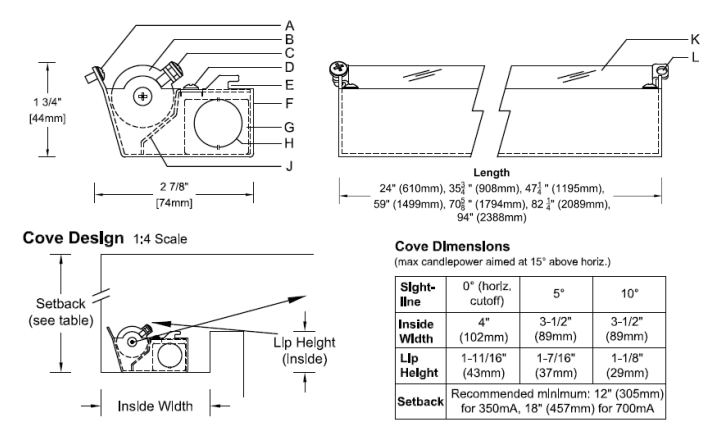

- A Mounting screws to framing\*
- B Extruded aluminum heat sink
- C Locking set screw to lock aiming
- D Driver cover screws
- E Slot, hooks into framing\*
- F Aluminum driver box/wire way
- G High power factor LED driver
- H 7/8" knock out for conduit and supply wiring (by others)
- J Formed aluminum driver cover
- K Extruded polymer beam shaping lens
- M Tab with screw for interlocking adjacent luminaires and locking aiming position

\*LumiLedge® cove framing ordered separately

## Specifications

### Housing and Optic Assembly:

Extruded aluminum heat sink/optic housing. Exterior heat sink anodized for maximum emissivity. Stainless steel end plates. Extruded acrylic refractive semi-diffuse asymmetric beam shaping lens. Extruded aluminum driver housing and removable cover.

### Finish:

Optic assembly – bright anodized aluminum. Housing and cover – mill finish aluminum or painted. Painted surfaces receive a 6-stage pretreatment process prior to electrostatically applied baked powder enamel.

All hardware – stainless steel.

### Mounting:

Base or wall mounted (fasteners by others). Luminaires can be mounted individually or joined together to form a continuous row. Optical assembly aiming is adjustable and is fixed in position by rotation locking screws at each side arm. When mounted in a continuous row, assemblies lock together allowing all in the row to be aimed together.

Fixture weight: 1.7 lb/ft (2.5 kg/m)

### Electrical:

Use 90°C wire for supply connections. Integral electronic Class II drivers. Driver/wireway compartment includes one conduit entry at each end. Channel cover is removable for access to driver and wiring. Luminaires may be butted end-to-end (connectors by others) for through wiring. Optional #12 AWG prewired modular through wiring with quick connectors.

Optional, compatible dimming controls (by others). See website for dimming compatibility and specifications.

### Standard:

UL ETL listed for dry locations, consult factory for damp location options.

5 year warranty, maximum ambient temperature 45°C (113°F).

## Controls

LiQ luminaires are compatible with a wide variety of wired and wireless controls and sensors. See [Controls Information](#).

**AWB-TP-DMX-0** = RGBW LED dimmer switch fits in a standard wall switch box and provides on/off control as well as fixed levels of dimmability. The dimmer switch has a color-selection wheel for thousands of color options, 10 dynamic color-changing/single color modes, 0-100% dimming, on/off controls, and 4 color-specific channel controls for red, green, blue, and white.

Additional wired and wireless controls available, see [Driver and Controls Information](#).



# Style K5-FR

LumiLedge® 5" Mini Knife Edge Cove Framing



## Features

- Factory painted white matte powder coat finish standard and in stock
- Custom finishing also available
- Designed to be field cut
- Prefabricated corners
- Patented two-piece design allows for secure mounting
- Two-piece design allows framing to be installed closer to the ceiling than field built coves: as close as 6" for accent lighting; 12" recommended

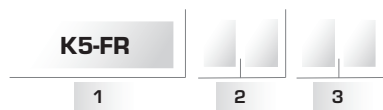

CATALOG NUMBER

### 1 PRODUCT

**K5-FR** = LumiLedge® 5" Mini Knife Edge Cove Framing

### 2 CONFIGURATION

**08** = 8ft. kit  
**32** = 32ft. kit  
**OC** = Outside corner kit  
**IC** = Inside corner kit  
**EC** = End Cap kit

### 3 FINISH

**22** = Matte White (standard)

## Dimensions

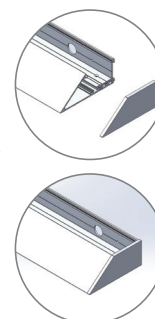
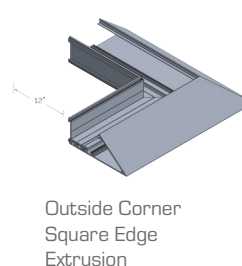
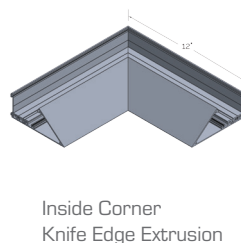
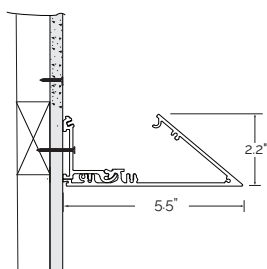
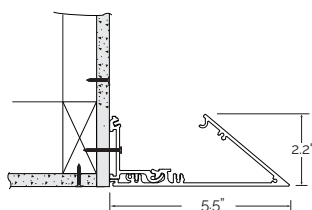

# Style K5-FC-FR

LumiLedge® Mini 5" Knife Edge  
Floating Ceiling Cove Framing

LiQ  
... Lighting IQ Rising  
The Lighting Quotient



## Features

- Factory painted white matte powder coat finish standard and in stock
- Custom finishing also available
- Designed to be field cut
- Prefabricated corners
- Patented two-piece design allows for secure mounting
- Two-piece design allows framing to be installed closer to the ceiling than field built coves: as close as 6" for accent lighting; 12" recommended
- Mud flange detail allows for seamless integration with floating ceiling

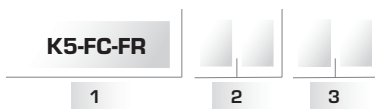

## CATALOG NUMBER

### 1 PRODUCT

**K5-FC-FR** = LumiLedge® Mini 5" Knife Edge Floating Ceiling Cove Framing

### 3 FINISH

**22** = Matte White (standard)

### 2 CONFIGURATION

**08** = 8ft. kit  
**32** = 32ft. kit  
**OC** = Outside corner kit  
**IC** = Inside corner kit  
**EC** = End Cap kit

## Dimensions

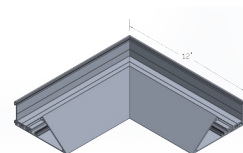
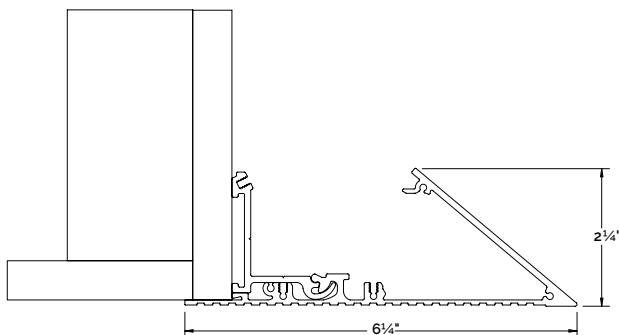

Inside Corner  
Knife Edge Extrusion

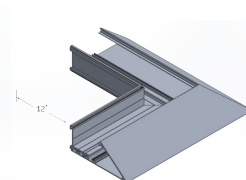

Outside Corner  
Square Edge  
Extrusion

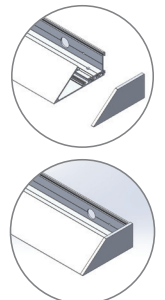



# Style LL5-FR

LumiLedge® 5" Mini Square Edge  
Cove Framing



## Features

- Factory painted white matte powder coat finish standard and in stock
- Custom finishing also available
- Designed to be field cut
- Prefabricated corners
- Patented two-piece design allows for secure mounting
- Two-piece design allows framing to be installed closer to the ceiling than field built coves: as close as 6" for accent lighting; 12" recommended



CATALOG NUMBER

### 1 PRODUCT

**LL5-FR** = LumiLedge® 5" Mini Square Edge Cove Framing

### 2 CONFIGURATION

**08** = 8ft. kit  
**32** = 32ft. kit  
**OC** = Outside corner kit  
**IC** = Inside corner kit  
**EC** = End Cap kit

### 3 FINISH

**22** = Matte White [standard]

## Dimensions

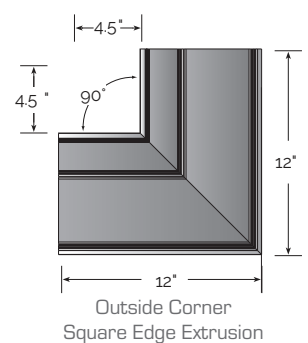
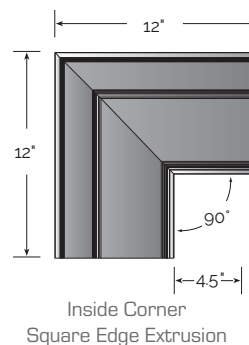
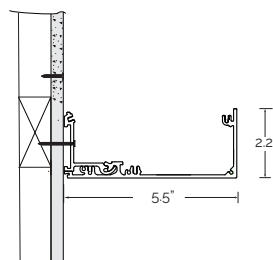
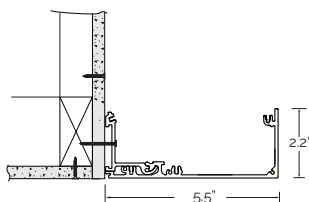

# Style LLSR-FR7

LumiLedge® Prefabricated 7"  
Square Edge Cove Framing



## Features

- Install alignment rail and clip on brackets to create a perfect cove frame
- Framing field finished with wall board for exact match to wall surfaces
- Factory precise forms make installation more cost effective than field built coves
- 3" high x 7" wide profile
- Field trimmable for exact wall fit
- Inside and outside corner kits available

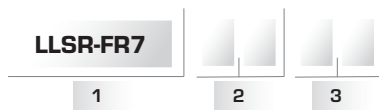

CATALOG NUMBER

### 1 PRODUCT

**LLSR-FR7** = LumiLedge® Prefabricated 7" Square Edge Cove Framing

### 3 FINISH

**00** = Mill finish Aluminum

### 2 CONFIGURATION

**08** = 8ft. kit  
**16** = 16ft. kit  
**40** = 40ft kit  
**OC** = Outside corner kit  
**IC** = Inside corner kit

## Dimensions

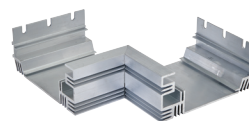
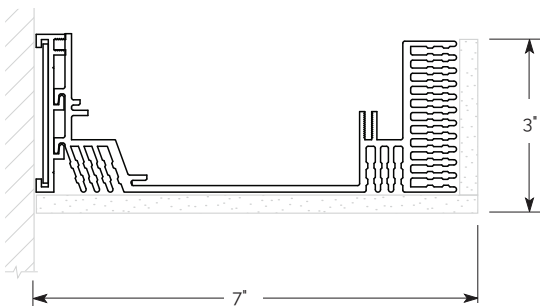

Inside Corner  
Square Edge Extrusion

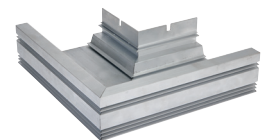

Outside Corner  
Square Edge Extrusion