

# style S222

Low profile semi-recessed,  
integral driver



Peter Daitch Gallery, Connecticut | Lighting Design: Connected Systems LLC | Photography: Caryn B. Davis



## Features

- Serviceable driver and light engine
- Low profile – minimal silhouette focuses attention on the luminous wall, not the luminaire
- Shallow recessed depth – fits under ducts at core walls
- Over 1640 lumens delivered @ only 15W input
- Wide lateral distribution allows greater on-center spacing

## Performance

Precisely extruded acrylic lens produces an asymmetric distribution ideal for illuminating vertical surfaces evenly from top to bottom.

L85(17k) > 104,000 hrs. @ 25°C per TM-21

For LM79 and photometric reports,  
visit [thelightingquotient.com](http://thelightingquotient.com)

PROJECT

TYPE

S

2

2

2

1

2

3

4

5

6

7

8

9

10

CATALOG NUMBER

1

STYLE

S222

=

Low profile semi-recessed wall washer; integral driver.

2

OUTPUT / POWER

S

=

Standard output

H

=

High output

3

LENGTH

ORDER CODE	LENGTH	LUMENS	INPUT WATTS
S-08	8"	877	7
H-08	8"	1605	15

Based on 3500K, 90+ CRI See

Scaled Performance Table

4

MOUNTING

T

=

Overlapping flange with spring clips for gypsum board wall

L

=

Overlapping flange with adjustable mounting brackets for accessible ceiling

P

=

Perforated plaster flange (trimless) for gypsum board ceiling

5

FINISH

\* non-cancellable/non-returnable

02

=

Semigloss White

06

=

Dark Bronze\*

07

=

Silver\*

08

=

Semigloss Black

13

=

Matte Black\*

15

=

Metallic\*

17

=

Champagne\*

18

=

Copper\*

22

=

Matte White\*

PL

=

Platinum\*

99

=

Custom or RAL (Consult Rep.)

02	22*	PL*	07*	15*
08	13*	06*	18*	17*

6

VOLTAGE

M

=

120-277V Universal voltage input

K

=

347V input

7

OPTIONS

(see Accessories Section for specifications)

VO

=

Visor

VM

=

Visor; modified for use in MRI medical facility (T mount only). MRI filters required on output of each remote driver. Consult factory prior to specification.

XX

=

For modification not listed, include detailed description. Consult factory prior to specification.

OO

=

No options

OB

=

Vertical blade baffle, 25° shielding, matte gray, indoor

OC

=

Modified to comply with Chicago plenum code

OP

=

For use in natatorium/ damp location

OM

=

For use in MRI medical facility (T mount only). MRI filters required on output of each remote driver.

XX

=

For modification not listed, include detailed description. Consult factory prior to specification.

8

DESTINATION REQUIREMENT

O

=

CSA certified for U.S.

J

=

CSA certified for Canada

9

COLOR TEMPERATURE / CRI

927

=

2700K, 90+ CRI

930

=

3000K, 90+ CRI

935

=

3500K, 90+ CRI

940

=

4000K, 90+ CRI

D2W

=

Dim-to-Warm 2200K-3000K, 90+ CRI, other CCTs available

TWH

=

Tunable White; 2700K-6500K, 90+ CRI

RGB

=

Color Tunable; RGBW with 3500K, 90+ CRI white

NOTE:

Additional CCT and CRI options are available; consult factory.

static white

Static

Dim 2 warm

Dim2Warm

tunable white

Tunable

rgbw

RGBW

10

DIMMING

OO

=

Non-dimming

ZX

=

0-10V analog dimming 120-277V or 347V input, dimming 100%-1%, 0-10V controls by others

TD

=

ERP forward or reverse phase 120V only, dimming 100%-6%, 120V phase controls by others

Remote Driver Options

EL

=

0-10V eldoLED SOLOdrive, 120-277V input, dimming 100%-0.1%, 0-10V controls by others

ED

=

DALI eldoLED SOLOdrive, 120-277V input, dimming 100%-0.1%, DALI controls by others

DZ

=

D2W or TWH 2-Channel driver for use with 0-10V controls by others

DD

=

D2W or TWH 2-Channel DALI driver (DALI controls by others)

DA

=

RGBW 4-Channel DMX module (DMX controls by others)

DM

=

RGBW 4-Channel eldoLED LINEARdrive (DMX controls by others)

## Lighting the Wall

Low profile semi-recessed, integral driver

### T Mount: Non-accessible Ceiling

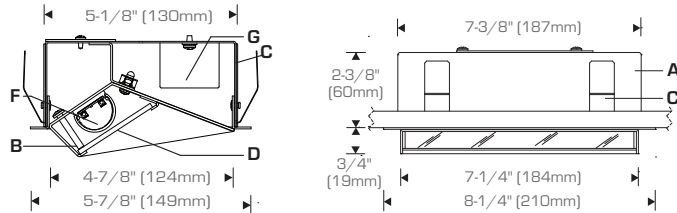

### L Mount: Accessible Grid Ceiling

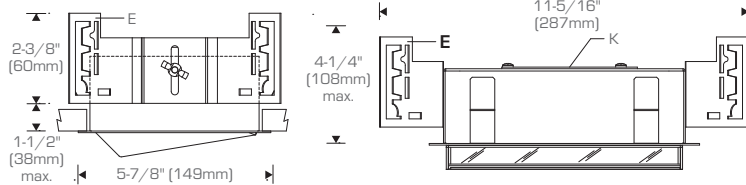

### P Mount: Non-accessible Ceiling

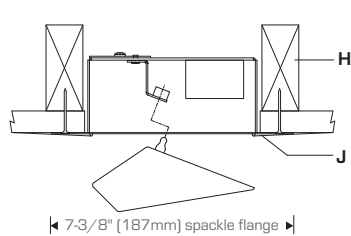

### Rough Opening



- A** Aluminum back box/trim frame
- B** Removable aluminum heat sink/housing
- C** Stainless steel mounting springs (4 included)
- D** Acrylic lens with elliptical diffusion
- E** Universal mounting brackets (L mount)
- F** Field serviceable light engine with asymmetric optic
- G** Integral constant current driver
- H** Supplemental framing/support (by others)
- J** Skim coat of plaster
- K** Wiring access plate

## Specifications

### Optical Assembly:

Formed aluminum housing, back box and trim frame; stainless steel hardware and spring mounting clips. Extruded aluminum heat sink, Precision extruded polymer refractive lens with optimized asymmetric distribution. Light engine may be removed for service or upgrade. Acrylic lens with elliptical diffusion maximizes lateral distribution without disturbing asymmetric forward throw.

### Finish:

Housing and back box/trim frame/cutoff visor finished in choice of matte or semigloss white. Painted surfaces – 6 stage pretreatment and electrostatically applied thermoset polyester powder coating for a durable abrasion, fade and corrosion resistant finish.

### Electrical:

Use 90°C wire for supply connections. Integral electronic HPF constant current driver with quick connector. Access plate on rear of back box with two 1/2" knockouts for supply wiring. Internal splice compartment allows for access to splices behind wall. For complete driver specifications, see website, reference document [MA-1303](#).

### Mounting (Lighting the Ceiling):

Luminaire installs from outside finished wall – up to 1-1/2" (38mm) thick.

**T** mount provided with overlapping trim and spring clips.

Fixture weight: .2 lbs (1.0 kg).

### Mounting (Lighting the Wall):

Luminaire installs from below finished ceiling – up to 1-1/2" (38mm) thick.

**T** mount provided with overlapping trim and spring clips for gypsum board/inaccessible ceilings.

**L** mount provided with overlapping trim and adjustable brackets for T-bar grid/accessible ceilings. Supplemental support wires, bar hangers, etc. (by others) required for accessible ceilings.

**P** mount (trimless) provided with perforated spackle flange for gypsum board/inaccessible ceilings. Supplemental framing and/or support required (by others).

Fixture weight: 2.2 lb (1.0 kg).

### Standard:

UL listed or CSA certified for dry locations.

Suitable for insulated walls (Type IC).

5 year warranty, maximum ambient temperature 45°C (113°F).

## Required Mounting Hangers

### Accessories

Order separately. See Accessories Section for specifications.

**AEJV** **000** = Vertical blade **baffle**, matte gray finish, indoor use  
**2** = 25° shielding

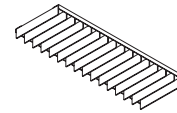

**AHC000** = **Accessory Hanger** Channel, pair of standard **mounting bars** 27" long, 3/4" high, C-channels

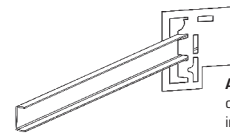

**AHC000** hanger channel shown inserted into **ASRBKT00**

## Controls

LiQ luminaires are compatible with a wide variety of wired and wireless controls and sensors. See [Controls Information](#).

**AWB-TP-DMX-0** = RGBW LED dimmer switch fits in a standard wall switch box and provides on/off control as well as fixed levels of dimmability. The dimmer switch has a color-selection wheel for thousands of color options, 10 dynamic color-changing/single color modes, 0-100% dimming, on/off controls, and 4 color-specific channel controls for red, green, blue, and white.

Additional wired and wireless controls available, see [Driver and Controls Information](#).

