

Style S108

Indoor linear, integral driver

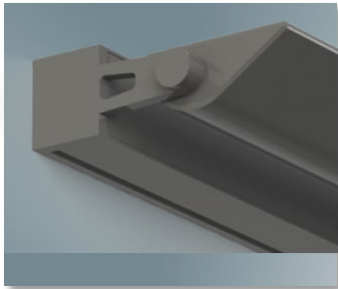

Jonathan Edwards College Servery, Yale University, CT | Architect: Newman Architects | Lighting Design: atelier ten | Photography: Peter Aaron, ESTO



Features

- Minimal size with powerful output and high efficacy
- Up to 3920 delivered lumens per foot
- Built-in visor provides horizontal cutoff to eliminate glare
- Asymmetric forward throw with adjustable aiming
- All aluminum and stainless steel construction
- Static white (2700K-4000K), Dim-to-Warm, Tunable White or RGBW

Performance

Precisely extruded acrylic lens produces an asymmetric distribution ideal for illuminating ceiling evenly.

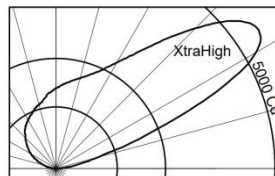

For LM79 and photometric reports, visit thelightingquotient.com

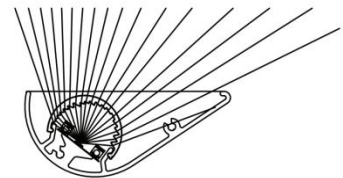

L85[17k] > 104,000 hrs. @ 25°C per TM-21

PROJECT

TYPE

S108

1 2 3 4 5 6 7 8 9 10

CATALOG NUMBER

1 STYLE

S108 = Linear Adjustable Asymmetric Uplight with integral driver

2 OUTPUT / POWER

L = Low output (3.3 W/ft)
S = Standard output (6.8 W/ft)
H = High output (14 W/ft)
E = Extra-high output (23 W/ft)
U = Ultra-high output (31 W/ft)

3 LENGTH

ORDER CODE	LENGTH	LUMENS	INPUT WATTS
2	2'	3649	28
3	3'	5473	42
4	4'	7279	52
5	5'	9122	70
6	6'	10946	83
7	7'	12770	97
8	8'	14595	111

Based on High Output: 3500K, 90+CRI
 See [Scaled Performance Table](#)

4 MOUNTING

H = For use with mounting hubs only or mounting hubs with surface, pendant or cantilever hangers (ordered and priced separately, see accessories).

5 FINISH * non-cancellable/non-returnable

02 = Semigloss White **13** = Matte Black* **22** = Matte White*
06 = Dark Bronze* **15** = Metallic* **PL** = Platinum*
07 = Silver* **17** = Champagne* **99** = Custom or RAL (Consult Rep.)
08 = Semigloss Black **18** = Copper*

02	22*	PL*	07*	15*
08	13*	06*	18*	17*

6 VOLTAGE

M = 120-277V Universal voltage input

7 OPTIONS (see Accessories Section for specifications)

00 = No options
0B = Cross baffle, provides 25° lateral shielding
0G = Gradient backslash reduction film

8 DESTINATION REQUIREMENT

0 = CSA certified for U.S.
J = CSA certified for Canada

9 COLOR TEMPERATURE / CRI

927 = 2700K, 90+ CRI **D2W** = Dim-to-Warm 2200K-3000K, 90+ CRI, other CCTs available
930 = 3000K, 90+ CRI **TWH** = Tunable White; 2700K-6500K, 90+ CRI
935 = 3500K, 90+ CRI **RGB** = Color Tunable; RGBW with 3500K, 90+ CRI white
940 = 4000K, 90+ CRI

NOTE: Additional CCT and CRI options are available; consult factory.



Static



Dim2Warm



Tunable



RGBW

10 DIMMING

00 = Non-dimming
ZX = 0-10V analog dimming 120-277V or 347V input, dimming 100%-1%, 0-10V controls by others
TD = ERP forward or reverse phase 120V only, dimming 100%-6%, 120V phase controls by others
EL = 0-10V eldoLED SOLOdrive, 120-277V input, dimming 100%-0.1%, 0-10V controls by others
ED = DALI eldoLED SOLOdrive, 120-277V input, dimming 100%-0.1%, DALI controls by others
DZ = D2W or TWH 2-Channel driver for use with 0-10V controls by others
DD = D2W or TWH 2-Channel DALI driver (DALI controls by others)
DA = RGBW 4-Channel DMX module (DMX controls by others)
DM = RGBW 4-Channel eldoLED LINEARdrive (DMX controls by others)

Lighting the Ceiling Indoor Linear with Integral Driver

Optical Assembly

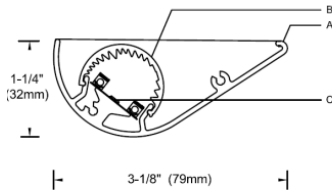

Length Chart

NOMINAL LENGTH	LENGTH
1FT	12-7/8" (327mm)
2FT	24-3/4" (629mm)
3FT	36" (921mm)
4FT	48" (1219mm)
5FT	60" (1524mm)
6FT	72" (1829mm)
7FT	84" (2134mm)
8FT	96" (2438mm)

- A** Extruded aluminum heat sink/housing
- B** Extruded semi-diffuse lens
- C** Linear LED PCB with mid-power LEDs
- D** Extruded aluminum driver housing
- E** Machined aluminum decorative knob
- F** Extruded aluminum heat sink/housing
- G** Aluminum support arm
- H** Universal voltage LED driver
- J** Aluminum decorative end plate

Low Profile (S-mount)

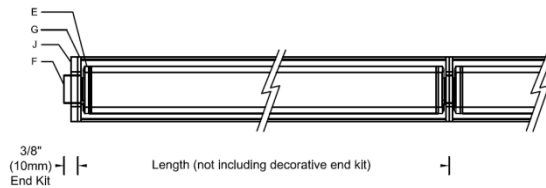
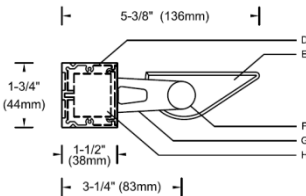

ADA Compliant (W-mount)

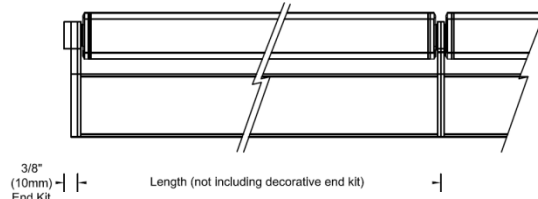
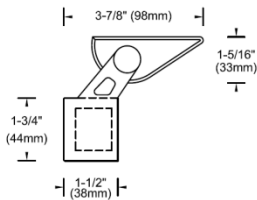

Lighting the Wall Indoor Linear with Integral Driver

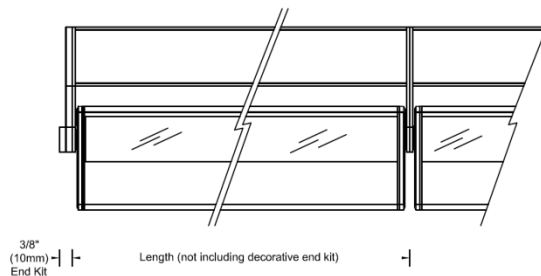
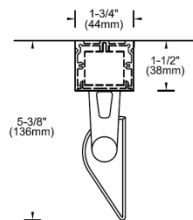

Specifications

Housing and Optic Assembly:

Extruded aluminum heat sink/optic housing. Exterior heat sink anodized for maximum emissivity. Extruded aluminum driver channel and snap-on cover. Aluminum side arms. Aluminum decorative end plates and knobs ordered separately for each individual luminaire or row of luminaires. Precision extruded impact resistant polymer refractive lens with optimal diffusion.

Finish:

Anodized extruded aluminum heat sink/housing with painted finish. Formed aluminum canopy, end hubs and stems painted white or black. All painted surfaces receive a 6 stage pretreatment and electrostatically applied thermoset polyester powder coating for a durable abrasion, fade and corrosion resistant finish – complies with UL 1598A Marine Grade Finish. All hardware – stainless steel.

Mounting:

Extruded aluminum driver channel is mounted to wall or ceiling surface. Luminaires may be mounted individually or end to end in rows. Optical assembly features fully adjustable aiming. Fixture weight: 1.8 lb/ft (2.7 kg/m).

Electrical:

Use 90°C wire for supply connections. Integral electronic HPF thermally protected Class 2 driver. For complete driver specifications, see website, reference document [MA-1303](#). Driver/wireway channel includes one conduit entry at each end and 2 in rear. Channel cover is removable for access to driver and wiring. Luminaires may be butted end-to-end (close nipple connectors by others) for through wiring. Optional #12 AWG prewired modular through wiring with quick connectors. Compatible dimming controls (by others).

Standard:

CSA certified for damp locations.
5 year warranty, maximum ambient temperature 45°C (113°F).

Required Accessories

Required End Plates:

ADE - AP - 0 = Decorative End Kit - pair of end plates and knobs, one pair required for each individual fixture or for each row of fixtures
5 = Finish (see page 2)
AP = Decorative End Kit for Style S108

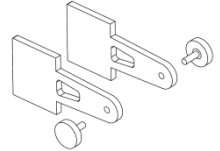

Controls

LiQ luminaires are compatible with a wide variety of wired and wireless controls and sensors. See [Controls Information](#).

AWB-TP-DMX-O = RGBW LED dimmer switch fits in a standard wall switch box and provides on/off control as well as fixed levels of dimmability. The dimmer switch has a color-selection wheel for thousands of color options, 10 dynamic color-changing/single color modes, 0-100% dimming, on/off controls, and 4 color-specific channel controls for red, green, blue, and white.

Additional wired and wireless controls available, see [Driver and Controls Information](#).

